

**BUILDING-STRUCTURE INVENTORY FORM**

DIVISION FOR HISTORIC PRESERVATION  
NEW YORK STATE PARKS AND RECREATION  
ALBANY, NEW YORK (518) 474-0479

FOR OFFICE USE ONLY \_\_\_\_\_

UNIQUE SITE NO. \_\_\_\_\_  
QUAD \_\_\_\_\_  
SERIES \_\_\_\_\_  
NEG. NO. \_\_\_\_\_

YOUR NAME: MARK PIERCE

DATE: Dec. 6, 1992

YOUR ADDRESS: 106 W. Sibley Hall

TELEPHONE: 607-256-5151

ORGANIZATION (if any): Preservation Planning Workshop, Cornell University

\*\*\*\*\*

**IDENTIFICATION**

- 1. BUILDING NAME(S):
- 2. COUNTY: Steuben TOWN/CITY: Corning VILLAGE:
- 3. STREET LOCATION: 227 Cedar Street
- 4. OWNERSHIP: a. public [ ] b. private [ X ]
- 5. PRESENT OWNER: Zia and Bernadette Haider ADDRESS: 227 Cedar St.
- 6. USE: Original: Residence Present: Residence
- 7. ACCESSIBILITY TO PUBLIC: Exterior visible from public road: Yes [ X ] No [ ]  
Interior accessible: Yes [ ] No [ X ] Explain: Private residence

**DESCRIPTION**

- 8. BUILDING MATERIAL: a. clapboard [ X ] b. stone [ ] c. brick [ ] d. board & batten [ ]  
e. cobblestone [ ] f. shingles [ ] g. stucco [ ] other:
- 9. STRUCTURAL SYSTEM: a. wood frame with interlocking joints [ ]  
b. wood frame with light members [ X ]  
c. masonry load bearing walls [ X ]  
d. metal (explain)  
e. other
- 10. CONDITION: a. excellent [ ] b. good [ X ] c. fair [ ] d. deteriorated [ ]
- 11. INTEGRITY: a. original site [ X ] b. moved [ ] if so, when?  
c. list major alterations and dates (if known): See Continuation Sheet



MAP:

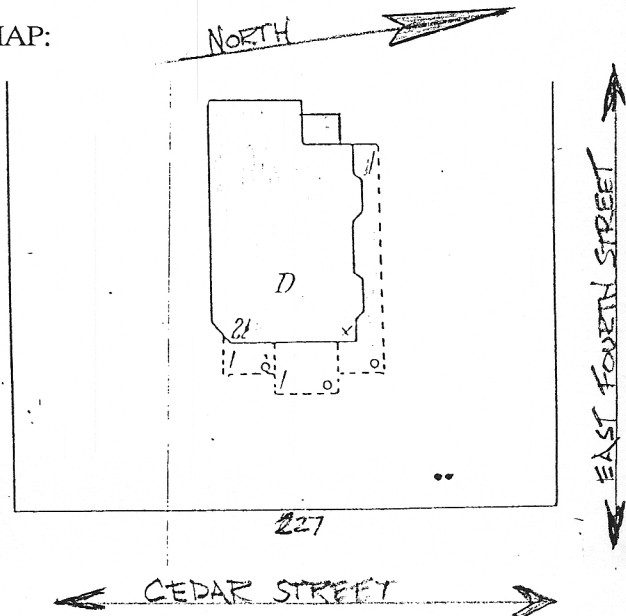

14. THREATS TO BUILDING: a. none known [ X ] b. zoning [ ] c. roads [ ]  
d. developers [ ] e. deterioration [ ]  
f. other:

15. RELATED OUTBUILDINGS AND PROPERTY:  
a. barn [ ] b. carriage house [ ] c. garage [ X ]  
d. privy [ ] e. shed [ ] f. greenhouse [ ]  
g. shop [ ] h. gardens [ ]  
i. landscape features  
j. other:

16. SURROUNDINGS OF THE BUILDING (check more than one if necessary):  
a. open land [ ] b. woodland [ ]  
c. scattered buildings [ ]  
d. densely built-up [ ] e. commercial [ ]  
f. industrial [ ] g. residential [ X ]  
h. other:

17. INTERRELATIONSHIP OF BUILDING AND SURROUNDINGS:  
(Indicate if building or structure is in an historic district)

See Continuation Sheet

18. OTHER NOTABLE FEATURES OF BUILDING AND SITE:  
(Including interior features if known):

See Continuation Sheet

### SIGNIFICANCE

19. DATE OF INITIAL CONSTRUCTION: ca. 1905

#### ARCHITECT:

The Elmira firm of Pierce and Bickford probably designed this house. See the C. W. Williams House in Ithaca, New York, designed by Pierce and Bickford, for a very similar design. As noted in Architects Of Standing Pierce And Bickford, ( Thesis by Roger Reed) " Pierce and Bickford produced at least a dozen variations of this design between 1902 and 1909".

#### BUILDER:

20. HISTORICAL AND ARCHITECTURAL IMPORTANCE:

See Continuation Sheet

21. SOURCES:

See Continuation Sheet

22. THEME:

11c. MAJOR ALTERATIONS AND DATES:

A small one-story addition was added to the west (rear) of this structure sometime between 1930 and 1972. It also appears that a bay window on the south side of the house was added <sup>during this</sup> ~~inc~~ ~~some~~ this time period between 1930 and 1972.

17. INTERRELATIONSHIP OF BUILDING AND SURROUNDINGS:

This residence is situated on the corner of East Fourth Street and Cedar Street. It is on the west side of Cedar Street. This house occupies a very large <sup>and beautiful tree</sup> ~~and beautiful tree~~ site. In fact, it takes <sup>the site</sup> ~~up~~ ~~incorporates~~ up three lots. This very large and highly ornamented house adds architectural interest to this neighborhood, which includes many examples of different styles of architecture.

18. OTHER NOTABLE FEATURES OF BUILDING AND SITE:

This very large and impressive residence displays a mix of architectural elements that identify it as being from the Neoclassical Style. The complex massing and the variety of complex and elaborate architectural detailing of this structure almost certainly identify it as a structure that was designed by an architect. This Neoclassical Style structure has a pedimented two story entry porch with a lower full-width one story porch on either side. This is identified in A Field Guide To American Houses (McAlester) as a relatively uncommon subtype of the Neoclassical style. McAlester goes on to note, "The revival of interest in classical models dates from the World's Columbian Exposition, held in Chicago in 1893. The expositions planners mandated a classical theme, and many of the best-known architects of the day designed dramatic colonnaded buildings arranged around a central court. The exposition was widely photographed, reported, and attended; soon these Neoclassical models became the latest fashion throughout the country." (346).

The front facade of this structure is symmetrically balanced and features an impressive two story portico over the main entrance. This is supported by four full height classical columns with ionic capitals. The pedimented gable of this two story portico rests on an entablature. Dentils ornament the top of the frieze, located just below the soffit, all around the house. This pedimented gable is sided with wood clapboards and also displays a half circle window. A wood shape over this round window that resembles the shape of a keystone adds ornamentation. The pedimented shape of this front entrance gable is repeated over the double doors of the main entrance. This two story portico is flanked by a one story porch on either side. This porch has an open rail with turned balusters. The roof line over the porches are ornamented by an intricate balustrade. The north facade of this structure displays two pedimented dormers. The western most dormer has a large palladian window. The wood keystone shape is repeated here over the center of the half round window. The eastern most pedimented dormer on this north side has a chimney extending up through it. This chimney is set flush with the wall of the house. There is a small window in this dormer on one side of the chimney and a wood louvered vent on the other side. This vent is the same size as the window. There is a one story structure that projects out slightly from the main part of the house and extends along the full length of the south facade. The edge of the roof of this one story projection is ornamented by the same intricate balustrade that is seen on the roof of the porches on the east (front) facade. There is a small second story porch over this one story south facade projection. The north facade of this structure repeats the style of the two pedimented dormers that are seen on the south facade. There is a bay window at the first floor level at about the center of the south facade.

CONTINUATION SHEET, page 2  
227 Cedar Street  
Corning, N Y.

20. HISTORICAL AND ARCHITECTURAL IMPORTANCE:

The property at 227 Cedar Street was owned by George L. Abbot in 1903, however it was probably not the Neoclassical structure that exists on that site today. Some time between 1903 and 1908 the structure that was at 227 Cedar Street in 1903 was replaced by the house that exists on this site at the present time. George Abbot was a partner with James Hoare in the J. Hoare Glass Company. This company manufactured cut glass products. As noted in An Illustrated Descriptive Review Of Corning (J.A. Miller Company) ( the J. Hoare Company) is prepared to make any design and match any piece of work in the world."...(The company) ...employs in all 150 men (and) the output of this great establishment is sold to such large firms as Tiffany, Gorham, and the Plated Ware Trade of New York City."

The house at 227 Cedar Street was probably designed by the architectural firm of Pierce and Bickford from Elimira N.Y. The C. W. Williams House in Ithaca N.Y. is remarkably similar to this house at Cedar Street in Corning. The Williams House was designed by Pierce and Bickford.(see Architects of Standing: Pierce and Bickford, Elimira New York, 1890-1932. thesis by Rodger Reed) Mr. Abbot lived in this house until 1911. C. Glen Cole purchased the house in 1912. Mr. Cole was the President of the Corning Building Company.

21. SOURCES:

Corning City Directories; Steuben County Deeds; Sanborn Fire Insurance Maps of Corning, 1893, 1888, 1898, 1903, 1908, 1921, 1930. An Illustrated Descriptive Review of Corning, N.Y. by the J. A. Miller Company, 1891.

MAP INFORMATION:

1903- A large two story house appears on this first available Sanborn map of this neighborhood.

1908- The house that matches the shape of the existing structure first appears.

1913- No change from 1908

1921- No change from 1913

1930- No change from 1921

CONTINUATION SHEET, page 3  
227 Cedar Street  
Corning, N. Y

CITY DIRECTORY INFORMATION:

1903- GEORGE L. ABBOT, partner in the J. Hoare Company; makers of cut glass

1905- No change

1907- No change

1909- No change

1911- C. Glen Cole, President of the Corning Building Company.

1913- No change

1917- No change

1920- No change

1923- Hattie Cole; widow of C. Glen Cole