



# BUILDING STRUCTURE INVENTORY FORM

NYS OFFICE OF PARKS, RECREATION  
& HISTORIC PRESERVATION  
DIVISION FOR HISTORIC PRESERVATION  
(518) 474-0479

FOR OFFICE USE ONLY

UNIQUE SITE NO. \_\_\_\_\_  
QUAD \_\_\_\_\_  
SERIES \_\_\_\_\_  
NEG. NO. \_\_\_\_\_

YOUR NAME: S. ELSPETH JANFIELD DATE: \_\_\_\_\_

YOUR ADDRESS: \_\_\_\_\_ TELEPHONE: \_\_\_\_\_

ORGANIZATION (if any): \_\_\_\_\_

\*\*\*\*\*  
**IDENTIFICATION**

1. BUILDING NAME(S): \_\_\_\_\_
2. COUNTY: SEUBEN TOWN/CITY: CORNING VILLAGE: \_\_\_\_\_
3. STREET LOCATION: 137 CHEMUNG STREET
4. OWNERSHIP: a. public  b. private
5. PRESENT OWNER: NONSALMARK ADDRESS: \_\_\_\_\_
6. USE: Original: RESIDENCE Present: \_\_\_\_\_
7. ACCESSIBILITY TO PUBLIC: Exterior visible from public road: Yes  No   
Interior accessible: Explain \_\_\_\_\_

**DESCRIPTION**

8. BUILDING MATERIAL: a. clapboard  b. stone  c. brick  d. board and batten   
e. cobblestone  f. shingles  g. stucco  other: NUKED SIDINGS
9. STRUCTURAL SYSTEM: (if known) a. wood frame with interlocking joints   
b. wood frame with light members   
c. masonry load bearing walls   
d. metal (explain) \_\_\_\_\_  
e. other \_\_\_\_\_
10. CONDITION: a. excellent  b. good  c. fair  d. deteriorated
11. INTEGRITY: a. original site  b. moved  if so, when? \_\_\_\_\_  
c. list major alterations and dates (if known):  
SEE CONTINUATION SHEET

12. PHOTO:

13. MAP:

11. INTEGRITY (major alterations):

The dates for the alterations to this structure are unknown at this time. The double porch on the east facade was added during this century, after 1930. The foundation on the main structure is concrete, while the porches foundation and stoop are brick. The structure was originally a T-form structure, with the top of the T at the west end. When the porches were added the north facade was filled in, creating a flat facade. The south facade still has its setback.

This double porch has been fully enclosed, with eight one-over-one double-hung sash on the upper east facade and one each on the north and south walls. The same style windows are present on the lower story east facade. Also present on the first story is an entry, with no door. On the north and south walls of the first story porch are paired three-light fixed windows.

A variety of siding materials have been used on the structure. The east facade features the following; first story porch, narrow blue horizontal aluminum, second story porch, narrow white vertical aluminum, gable end wide white horizontal aluminum. The north and south facades; first story porch and main structure, blue wood panel (similar to interior panelling), second story porch, narrow white horizontal aluminum, second story main structure, wide white horizontal aluminum. West facade features the same material as the first story's east and west facades.

17. INTERRELATIONSHIP OF BUILDING AND SURROUNDINGS:

This structure is situated on the west side of Chemung Street, across from the Corning Hospital. This block of Chemung Street features a variety of small to mid-sized vernacular structures, most built after the turn of the twentieth century. The setbacks are similar on each property. This particular structure was built prior to 1888, although it has since been moved on its lot.

18. OTHER NOTABLE FEATURES OF BUILDING AND SITE:

This structure, built before 1888, was a T-form vernacular Queen Anne with steep pitch cross gable roof. According to *A Field Guide to American Houses* (McAlester) the Queen Anne Style was inspired by the work of English Architect Richard Norman Shaw. Although the name Queen Anne is inaccurate, the style has been referred to by that name since it was introduced to this country in the 1870s. The style is noted for its eclectic nature and great variety of decorative motifs, the primary characteristic is

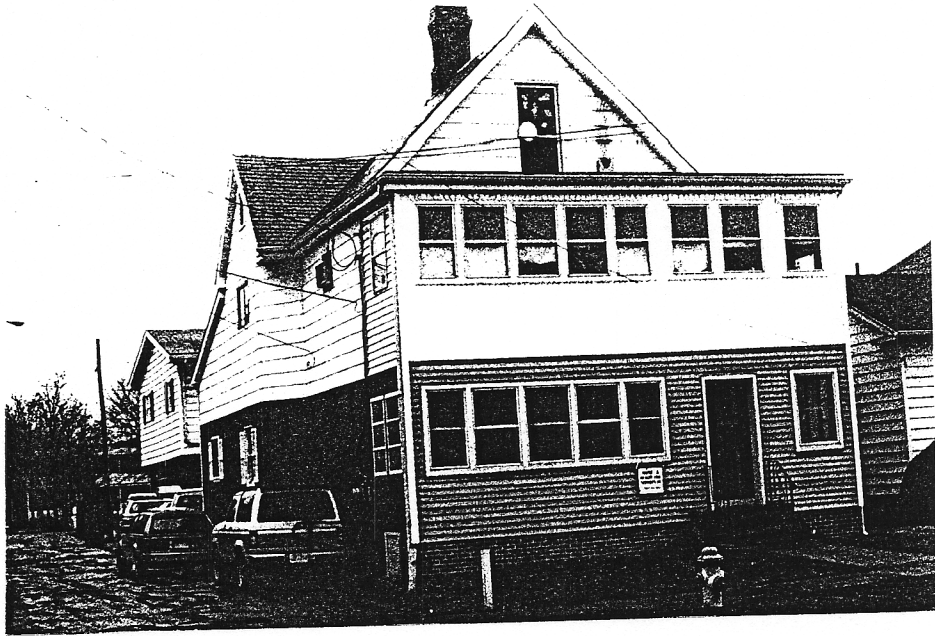

137 Chemung