

#pUGÆ"##Æ"#####P###D#####y%##^,###,##  
#

,##L#####V,####V,####V,##### #□#D#λ=D/#####D#D#####V,#####  
#####  
#####

FOR OFFICE USE ONLY

BUILDING-STRUCTURE INVENTORY FORM

UNIQUE SITE NO.

DIVISION FOR HISTORIC PRESERVATION  
NEW YORK STATE PARKS AND RECREATION  
ALBANY, NEW YORK (518) 474-0479

QUAD  
SERIES  
NEG. NO.

YOUR NAME: Kerri King  
YOUR ADDRESS: 106 W. Sibley Hall, Ithaca, NY  
ORGANIZATION (if any): Cornell University

DATE: Fall 1993  
TELEPHONE: (607)255-4331

\*\*\*\*\*

IDENTIFICATION

- 1. BUILDING NAME(S):
- 2. COUNTY: Steuben TOWN/CITY: Corning VILLAGE:
- 3. STREET LOCATION: 94 East Fifth Street
- 4. OWNERSHIP: a. public [ ] b. private [X]
- 5. PRESENT OWNER: Ken A. Miller ADDRESS: 94 E. Fifth Street
- 6. USE: Original: single family residence Present: single family residence
- 7. ACCESSIBILITY TO PUBLIC: Exterior visible from public road Yes[X] No [ ]  
Interior accessible: Yes [ ] No [X] Explain: Private Residence

DESCRIPTION

- 8. BUILDING MATERIAL: a. clapboard[ ] b. stone[ ] c. brick[ ] d. board & batten [ ]  
e. cobblestone[ ] f. shingles[X] g. stucco[ ] other:
- 9. STRUCTURAL SYSTEM: a. wood frame with interlocking joints[ ]  
b. wood frame with light members[X]  
c. masonry load bearing walls[ ]  
d. metal (explain)  
e. other
- 10. CONDITION: a. excellent[ ] b. good[X] c. fair[ ] d. deteriorated[ ]
- 11. INTEGRITY: a. original site[X] b. moved[ ] if so, when?  
c. list major alterations and dates (if known): See Continuation Sheet
- 12. PHOTO: 13. MAP:

14. THREATS TO BUILDING: a. none known[X] b. zoning[ ] c. roads[ ]  
d. developers[ ] e. deterioration[ ]  
f. other:

15. RELATED OUTBUILDINGS AND PROPERTY:  
a. barn[ ] b. carriage house[ ] c. garage[X]  
d. privy[ ] e. shed[ ] f. greenhouse[ ]  
g. shop[ ] h. gardens[ ]  
i. landscape features: See Continuation Sheet  
j. other:

16. SURROUNDINGS OF THE BUILDING (Check more than one if necessary)  
a. open land[ ] b. woodland[ ]  
c. scattered buildings[ ]  
d. densely built-up[ ] e. commercial[ ]  
f. industrial[ ] g. residential[X]  
h. other:

17. INTERRELATIONSHIP OF BUILDINGS AND SURROUNDINGS:

See Continuation Sheet

18. OTHER NOTABLE FEATURES OF BUILDING AND SITE:  
(Including interior features if known):

See Continuation Sheet

#### SIGNIFICANCE

19. DATE OF INITIAL CONSTRUCTION: ca. 1890

ARCHITECT:

BUILDER:

20. HISTORICAL AND ARCHITECTURAL IMPORTANCE:

See Continuation Sheet

21. SOURCES:

See Continuation Sheet

22. THEME:

#### 11c. MAJOR ALTERATIONS AND DATES:

There have been several alterations to the exterior of this house. Around 1905, a room was added to the southern side of the house and a privy, which was torn down approximately six years after it was constructed, was built toward the center of the lot. A garage was added at the southwestern corner of the lot ca. 1918. The footprint of the house has changed considerably in the past century. According to 1893 maps, the home was a gabled-ell, open to the northeast corner of the lot. At unknown dates, there was an addition of a two-story gable to the east of the north/south wing, a two-story gabled addition (with clipped corners and a lower roofline than the other gabled addition) to the west of the north/south wing, and an extension of the north-facing gabled wing to the east. This last addition continues the roofline of the original north/south wing of the gabled-ell and includes a rectangular window. More recently, the family room and kitchen on the west side of the house were enlarged by approximately 4' x 20' x 9' in May 1978 with a single story, shed-roofed addition, the roof was reshingled by Cecce Construction in October 1992, and the patio on the eastern side of the house was screened in by Gary Miller in August 1991. At an unknown date, a rectangular window was replaced with a smaller, octagon window centered in the northern gable end and above a projecting bay.

#### 17. INTERRELATIONSHIP OF BUILDINGS AND SITE:

Built on a corner lot, this home features a back yard that is very visible from Wall Street. Its setback is equal to that of its neighbor to the west but the other houses along this section of East Fifth Street have shallower setbacks. This side of East Fifth Street is also higher in elevation than the opposite side of the street.

#### 18. OTHER NOTABLE FEATURES OF BUILDING AND SITE:

This two-story home has been so heavily altered that there is no one characteristic architectural style distinguishable. The dwelling is an example of the cottage-style houses abundantly found in this neighborhood. The foundation of the house is rough-cut Corning siltstone, the walls are clad in wood shingles, and the roof is covered in asphalt shingles.

The main entrance to this house is found on the eastern facade, in a two-story projecting addition. The entryway is flanked with fluted Doric pilasters and a brick veneer on the first floor. Surrounding the single door is a full transom light in a simple entablature enframingent. The opening in the entry way is of a continuous course of glass block. According to A Field Guide to American Houses, these characteristics are Greek Revival in style; elaborate door surrounds are a dominant feature in houses of this style. In addition, the pilasters feature bases and capitals, which are classical features, and as the McAlester book states, pilasters are frequent Greek Revival features. The wall above the door opening is clad in wood shingles and features a symmetrically placed one-over-one-light double-hung sash and a vent under the eave. To the south of the entrance gable is a single story, shed-roofed porch with screened openings. The closed porch features shingled walls and has a centered triangular pediment within the roofline. Inside the porch is a bay window featuring a copper awning. An identical window is found on the southern end of the house, centered in the original ell.

CONTINUATION SHEET, Page 2

94 East Fifth Street  
Corning, New York

#### 18. OTHER NOTABLE FEATURES OF BUILDING AND SITE ( continued):

On the southern elevation, the eave of the original ell is continued to the east because of a one-story addition to the house. The eave flares at the end of this addition and the height of the eave at this northeast corner of the house is approximately half of the height of the east porch. The western corner of the northern facade is clipped, a feature found on many Queen Anne-styled houses. The western and southern facades of the house feature the same materials and eclectic detail as the eastern and northern sides, however the latter facades are the most prominent because the house is situated on a corner lot.

The garage located on this property features the same foundation and cladding materials as the house. The roof of the garage, while covered in asphalt shingles, has a pyramidal roof.

#### 20. HISTORICAL AND ARCHITECTURAL IMPORTANCE:

This house was built on the partial Lot #8 of Block 53, as laid out in Brewer and Canfield's 1855 map of Corning. While maps dating to the 1860s do not show this house, a 1893 map shows the house in its original form. The owner of the house at that time was Henry E. Elwood. Because Elwood was a prosperous station agent for the DL & W Railroad depot in Gibson, dealing in coal and wool under the name of Elwood and Edger, it is probable that he built this house for his family. Although there is no record of Henry Elwood in the 1875 Corning city directory, he is listed in the directories from the 1890s. By the beginning of the 1910s, a Mrs. Emory E. Elwood is listed as the occupant of the house on East Fifth Street.

For the next few years, the house had several short-term owners. Around 1919, Jesse Littleton, the inventor of Pyrex, lived in the house but by 1923, the dwelling stood vacant. In 1925, W. Kenneth Norton, the secretary-treasurer of Rockwell Co. lived there. Two years later, George Tobias, of Ellison and Company had purchased the house. From 1931 to around 1940, Albert S. Eggleton, an employee of Corning Glass Works as the supervisor of exports, lived at 94 East Fifth Street. By 1944, George Keenan, who owned a truck service and dealership on Bridge Street, was living in the house.

#### 21. SOURCES:

Auwaerter, John. Reconnaissance Level Survey: Southside Neighborhood Proposed Historic District, Corning, New York. Ithaca: Cornell University, September, 1991.

Corning City Directories, Hanford 1893-1920, Manning 1921-1968.

McAlester, Virginia and Lee. A Field Guide to American Houses. New York: Alfred A. Knopf, 1991.

Map of Corning. Buffalo: H. Brewer and C. A. Canfield, 1855.

CONTINUATION SHEET, Page 3  
94 East Fifth Street  
Corning, New York

#### 20. SOURCES (continued):

Map of Corning. Corning: Harry C. Heermans, City Engineer, 1893.

Sanborn Map Company. Fire Insurance Maps of Corning, New York, (1903, 1908, 1914, 1921, and 1930).

Steuben County Deed Records. Steuben County Clerk's Office, Bath, New York.

#### ADDITIONAL PHOTOGRAPHS:

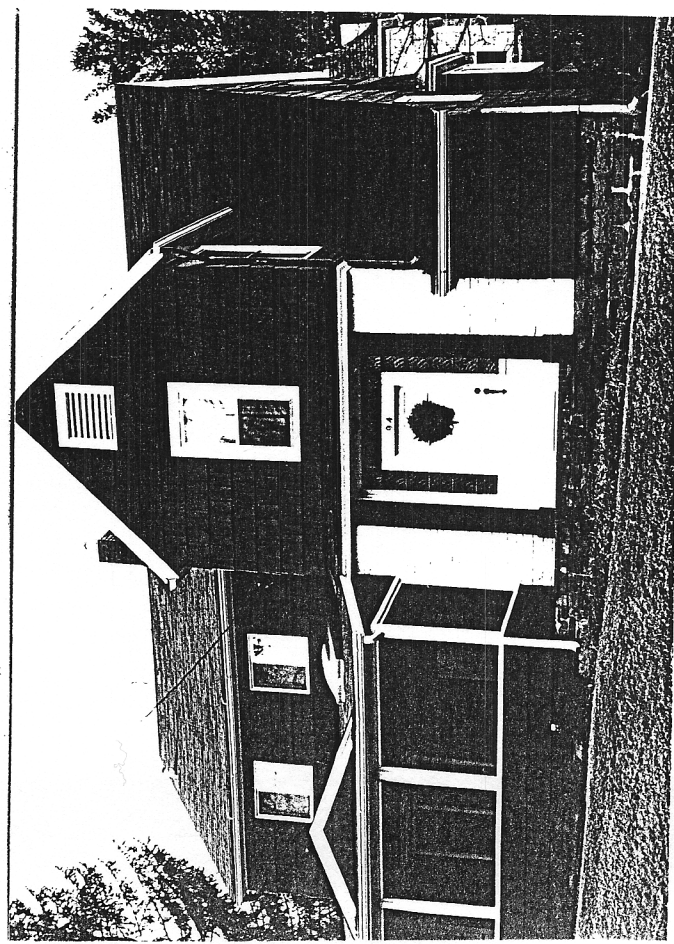

94 East 5th



94. East 5th