

**BUILDING-STRUCTURE INVENTORY FORM**

FOR OFFICE USE ONLY

DIVISION FOR HISTORIC PRESERVATION  
NEW YORK STATE PARKS AND RECREATION  
ALBANY, NEW YORK (518) 474-0479

UNIQUE SITE NO. \_\_\_\_\_  
QUAD \_\_\_\_\_  
SERIES \_\_\_\_\_  
NEG NO \_\_\_\_\_

YOUR NAME: Jeffrey A. Harris  
YOUR ADDRESS: 106 W. Sibley Hall

DATE: December 16, 1992

ORGANIZATION (if any): Preservation Planning Workshop, Cornell University  
TELEPHONE: \_\_\_\_\_

\*\*\*\*\*

**IDENTIFICATION**

- 1. BUILDING NAME(S): \_\_\_\_\_
- 2. COUNTY: Steuben TOWN/CITY: Coming VILLAGE: \_\_\_\_\_
- 3. STREET LOCATION: 69 East Fourth Street
- 4. OWNERSHIP: a. public [ ] b. private [ x ]
- 5. PRESENT OWNER: Joseph A. Eavisotto
- 6. USE: Original: residence ADDRESS: 69 East Fourth Street  
Present: residence
- 7. ACCESSIBILITY TO PUBLIC: Exterior visible from public road: Yes [ x ] No [ ]  
Interior accessible: Yes [ ] No [ x ] Explain: private residence

**DESCRIPTION**

- 8. BUILDING MATERIAL: a. clapboard [ x ] b. stone [ ] c. brick [ ] d. board & batten [ ]  
e. cobblestone [ ] f. shingles [ ] g. stucco [ ] other: \_\_\_\_\_
- 9. STRUCTURAL SYSTEM: a. wood frame with interlocking joints [ ]  
b. wood frame with light members [ x ]  
c. masonry load bearing walls [ ]  
d. metal (explain) \_\_\_\_\_  
e. other \_\_\_\_\_
- 10. CONDITION: a. excellent [ x ] b. good [ ] c. fair [ ] d. deteriorated [ ]
- 11. INTEGRITY: a. original site [ x ] b. moved [ ] if so, when? \_\_\_\_\_  
c. list major alterations and dates (if known): See Continuation Sheet
- 12. PHOTO: \_\_\_\_\_

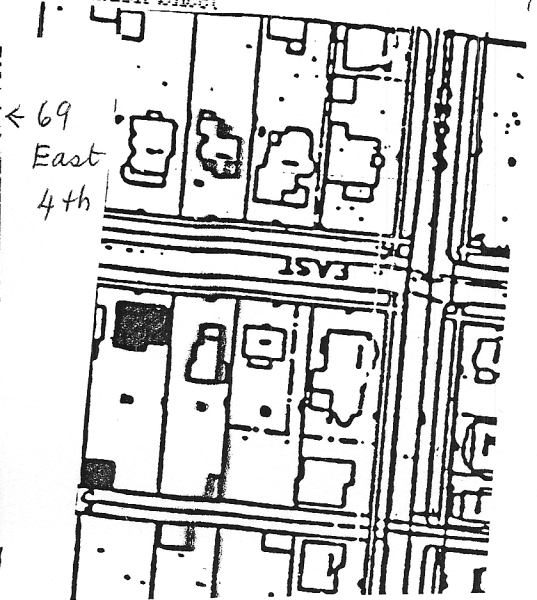

14. THREATS TO BUILDING:

- a. none known  b. zoning  c. roads
- d. developers  e. deterioration
- f. other:

15. RELATED OUTBUILDINGS AND PROPERTY:

- a. barn  b. carriage house  c. garage
- d. privy  e. shed  f. greenhouse
- g. shop  h. gardens
- i. landscape features
- j. other:

16. SURROUNDINGS OF THE BUILDING (check more than one if necessary):

- a. open land  b. woodland
- c. scattered buildings
- d. densely built-up  e. commercial
- f. industrial  g. residential
- h. other:

17. INTERRELATIONSHIP OF BUILDING AND SURROUNDINGS:

(Indicate if building or structure is in an historic district)

See Continuation Sheet

18. OTHER NOTABLE FEATURES OF BUILDING AND SITE:

(Including interior features if known):

See Continuation Sheet

**SIGNIFICANCE**

19. DATE OF INITIAL CONSTRUCTION: ca. ~~1875~~

ARCHITECT: Unknown

BUILDER: Thomas Lawrence?

*house  
built  
on existing  
foundation*

20. HISTORICAL AND ARCHITECTURAL IMPORTANCE:

See Continuation Sheet

21. SOURCES:

See Continuation Sheet

22. THEME:

Continuation Sheet, Page 1  
69 East Fourth Street  
Corning, New York

11c. MAJOR ALTERATIONS AND DATES:

North wing and one-story block added: Before 1903  
Wraparound porch removed, rear porch added: Since 1948  
14' x 15' rear deck added: 1991

← No house built new  
on old fieldstone  
foundation, RW Baker

17. INTERRELATIONSHIP OF BUILDING AND SURROUNDINGS:

This residence, located on the north side of East Fourth Street, is situated amongst an eclectic mix of houses of a variety of architectural styles, including the Queen Anne, Italianate, and Colonial Revival Styles. There is a wide variety of sizes to these homes, which are situated along both sides of the street with irregular spacing and setback widths. The houses on this block are all located at the southern end of their narrow lots, and have expansive rear yards sloping down to the north towards the alley, which bisects the block. This residence is situated quite close to the street, and the land drops off sharply to the north from the front yard.

18. OTHER NOTABLE FEATURES OF BUILDING AND SITE:

The basic form of 69 East Fourth Street is determined by three two-story gabled blocks of similar dimension. One is oriented perpendicular to the street, with its gable ends facing north and south, while another extends to the east from this one, set back approximately 8' from the former's south gable end. A third wing protrudes to the north from the center of this block. They rest upon fieldstone foundations, and feature low-sloping gable roofs which come down just above the second-story windows, with slight overhangs. On the front (south) facade, the gable end of the western wing has a symmetrical arrangement of window openings, with a wide, multiple-light fixed window on the first-floor level and two six-over-six double-hung sash on the second story. The windows are flanked by louvered wood shutters, as are all of the other windows on the house. On the eastern wing, set back from this gable end, are two bays of openings. The entrance is located just adjacent to the protruding wing, and features an elliptical opening with the entry door deeply recessed into the wall. The paneled wood door, with an aluminum storm door, is flanked by shutters and topped by an elliptical fan light. A small square stoop, three-steps-high, is situated directly in front of the entrance. To the east of the entrance is a six-over-six sash window, and two slightly shorter sash punctuate the second-floor level. A one-story porch originally extended in front of this wing and wrapped around the east facade of the house.

This east facade features the gable end of the eastern wing and one side of the wing extending to the north. The gable end has a wide bay protruding from the first-floor level, containing a fixed, multiple-light window similar to the one on the front (south) facade. Two sash are located on the second story. The north wing features an irregular arrangement of six-light casement windows on the first floor and sash on the second story. On the west facade, a brick chimney rises along the center of the wall, flanked by sash windows on both floors. On the rear of this west wing is a one-story extension, with a shallow-sloped roof trimmed by a decorative balustrade. To the north of this extends a shed-roof screened porch, fronted by a wood deck. The rear (north) facades of the two gable ends contain both sash and casement windows. To the north of the deck is a 24' x 36' in-ground swimming pool, and a 20' x 15' gable-roof garage is located on the northern edge of the property, next to the alley.

## 20. HISTORICAL AND ARCHITECTURAL IMPORTANCE:

This residence is one of the oldest in this part of the Southside Neighborhood, but alterations to its exterior have completely masked its original appearance. The original house probably was made up of the two wings closest to the street, forming an L-shaped block, with a one-story porch in front of the east wing. This arrangement is reminiscent of the Greek Revival, and probably dates the house to the early 1870s. Later additions expanded the house to the north, when the porch may have been extended around to the east facade. 69 East Fourth Street was originally owned and occupied by Thomas H. Lawrence, a prominent figure in Corning at that time. Originally a carpenter, it is possible that Mr. Lawrence was responsible for the construction of his house. In 1877, together with Harry C. Heermans, he secured a lease of the Corning Water Works, assuming responsibility for the management, extension, and maintenance of the city's water supply. The system had originally been set up for fire protection only, and through the efforts of the two men, a successful city-wide water supply system was established. The two men continued to oversee the system for the next thirty years. In addition, they established a firm, Heermans and Lawrence, contracting in steam heating, plumbing work, and supplies. Their office was located on Pine Street at the corner of East Erie Avenue. From 1946 to 1969, the house was inhabited by Harry B. Ecker, Jr. proprietor of the Ecker Drug Store on Market Street.

## 21. SOURCES:

Corning City Directories; Steuben County Deeds; Sanborn Fire Insurance Maps of Corning, 1903, 1908, 1913, 1918, 1923, 1930, 1948; Assessment Records; Bird's-Eye View of Corning, 1882; City of Corning, Corning; Harry C. Heermans, City Engineer, 1893; Building Permit Records; Hakes, Harlo. Landmarks of Steuben County. Syracuse: D. Mason & Company, 1896.

-----  

### MAP INFORMATION:

1882 - House exists, according to Bird's-Eye View.

1893 - House exists at 69 East Fourth Street, with name, "Thos. Lawrence."

1903 - Wood-framed house exists at 69 East Fourth Street.

### CITY DIRECTORY INFORMATION:

1874-75 - Thomas Lawrence, carpenter, home at Fourth near Wall.

1893 - Thomas Lawrence (Heermans & Lawrence), home at 69 East Fourth.  
Heermans & Lawrence, Corning Water Works, plumbing, heating, etc., Heermans & Lawrence block, Pine corner of East Erie Avenue.

### DEED INFORMATION:

Continuation Sheet, Page 3  
69 East Fourth Street  
Corning, New York

October 2, 1863 - John J. Olcott, of Albany, to Mechanics' and Farmers' Bank of Albany, NY. Book  
98, page 458.

March 22, 1875 - Mechanics' and Farmers' Bank of Albany, NY to Thomas Lawrence, Lot 12, Block  
51, for \$500. Book 162, page 230.