

BUILDING-STRUCTURE INVENTORY FORM

FOR OFFICE USE ONLY _____

DIVISION FOR HISTORIC PRESERVATION
NEW YORK STATE PARKS AND RECREATION
ALBANY, NEW YORK (518) 474-0479

UNIQUE SITE NO. _____
QUAD _____
SERIES _____
NEG. NO. _____

YOUR NAME: Jeffrey A. Harris

DATE: December 18, 1992

YOUR ADDRESS: 106 W. Sibley Hall

TELEPHONE: _____

ORGANIZATION (if any): Preservation Planning Workshop, Cornell University

IDENTIFICATION

- 1. BUILDING NAME(S): _____
- 2. COUNTY: Steuben TOWN/CITY: Corning VILLAGE: _____
- 3. STREET LOCATION: 224 Wall Street
- 4. OWNERSHIP: a. public [] b. private [x]
- 5. PRESENT OWNER: Lynne H. Collins ADDRESS: 224 Wall St.
Present: residence
- 6. USE: Original: residence
- 7. ACCESSIBILITY TO PUBLIC: Exterior visible from public road: Yes [x] No []
Interior accessible: Yes [] No [x] Explain: private residence

DESCRIPTION

- 8. BUILDING MATERIAL: a. clapboard [] b. stone [] c. brick [] d. board & batten []
e. cobblestone [] f. shingles [x] g. stucco [] other: _____
- 9. STRUCTURAL SYSTEM: a. wood frame with interlocking joints []
b. wood frame with light members [x]
c. masonry load bearing walls []
d. metal (explain) _____
e. other _____
- 10. CONDITION: a. excellent [] b. good [x] c. fair [] d. deteriorated []
- 11. INTEGRITY: a. original site [x] b. moved [] if so, when? _____
c. list major alterations and dates (if known): See Continuation Sheet

12. PHOTO: _____

13. MAP

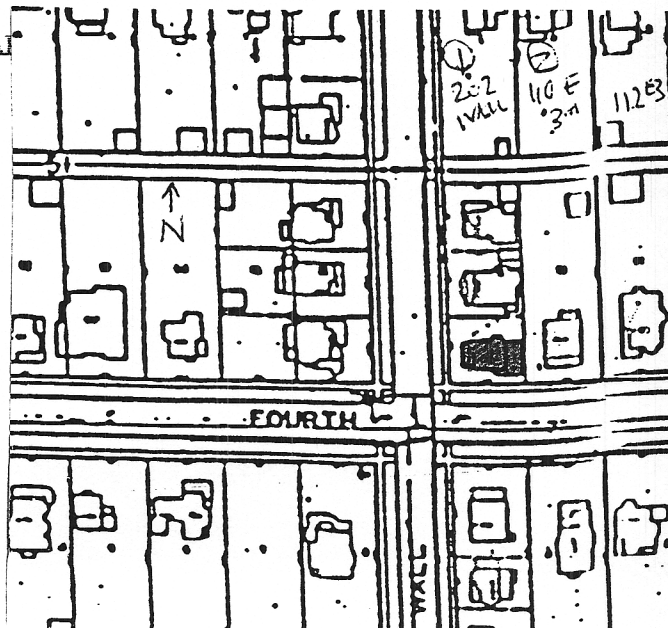

14. THREATS TO BUILDING: a. none known b. zoning c. roads
d. developers e. deterioration
f. other:

15. RELATED OUTBUILDINGS AND PROPERTY:
a. barn b. carriage house c. garage
d. privy e. shed f. greenhouse
g. shop h. gardens
i. landscape features
j. other:

16. SURROUNDINGS OF THE BUILDING (check more than one if necessary):
a. open land b. woodland
c. scattered buildings
d. densely built-up e. commercial
f. industrial g. residential
h. other:

17. INTERRELATIONSHIP OF BUILDING AND SURROUNDINGS:
(Indicate if building or structure is in an historic district)

See Continuation Sheet

18. OTHER NOTABLE FEATURES OF BUILDING AND SITE:
(Including interior features if known):

See Continuation Sheet

SIGNIFICANCE

19. DATE OF INITIAL CONSTRUCTION: ca. 1882

ARCHITECT: Unknown

BUILDER: Unknown

20. HISTORICAL AND ARCHITECTURAL IMPORTANCE:

See Continuation Sheet

21. SOURCES:

See Continuation Sheet

22. THEME:

Continuation Sheet, Page 1
224 Wall Street
Corning, New York

11c. MAJOR ALTERATIONS AND DATES:

One-story addition to rear of house, bay window addition on north facade: 1882-1893
North porch addition, full-width front porch removed: Since 1948
Rear deck addition: ca. 1990

17. INTERRELATIONSHIP OF BUILDING AND SURROUNDINGS:

Located on the east side of Wall Street, this residence is surrounded by single family homes dating from the late nineteenth century. Like many houses along this street, it sits upon one of three parcels of land subdivided from a single lot at the corner of the blocks. This arrangement is characteristic of the streets running from north to south in the Southside Neighborhood grid. It produces an even spacing of buildings and consistent setbacks, but severely restricts the size of rear and side yards. The house is prominently located on the corner of Wall and East Fourth Streets, with houses closely situated on the north and east edges of its property. On this part of Wall Street, the land slopes down fairly steeply to the north.

18. OTHER NOTABLE FEATURES OF BUILDING AND SITE:

224 Wall Street is a typical example of the "box-like" Italianate-style homes found throughout the surrounding neighborhood. In Corning, most of these were built during the post-Civil War era up until the early 1880s, and this particular structure appears to be a somewhat later example of the style. Its two-story height, three-bay width, and side-hall entrance are common characteristics of this subtype of the Italianate Style. Other identifying features are the hipped roof with a wide overhang and the vertical emphasis to the window openings.

The shape of the primary block of the house is nearly square, rising to a height of two stories. Projecting from this central mass is a one-story addition at the rear of the house, which wraps around the southeast corner. An open porch and a one-story, five-sided, semi-octagonal bay project from the north side. The house is entirely clad in wood shingles and rests upon a fieldstone foundation. Little ornamentation can be found on this house: the wide soffits feature a simple trim, the window openings have wood casings of minimal embellishment, and the supporting corner piers of the side porch are only decorated with plain, square capitals and bases. The front (west) facade is three bays wide, featuring six-over-one sash windows behind modern storm windows. A one-story porch originally stretched across the front of this facade, but it has been replaced by a one-bay-wide porch near the southern edge of the facade. The main entrance to the house is located under this porch. This entrance features a single paneled wood door behind an aluminum storm door, flanked by sidelights and simple trim. The regular spacing of openings on the west facade is contrasted by the seemingly random placement of window and door openings on the secondary facades of the building. Here, the window treatment remains the same, and doors lead both to the side porch and rear deck.

20. HISTORICAL AND ARCHITECTURAL IMPORTANCE:

Available documentation and visual evaluation of 224 Wall Street indicates that it was probably one of the

Continuation Sheet, Page 2
224 Wall Street
Corning, New York

earliest buildings in this area of the Southside Neighborhood. Many of the homes built along East Fourth Street and upper Wall Street did not appear until the late 1800s, when the demand for housing as a result of the success of the railroads and Corning Glass Works created a building boom in this area. Its simple decoration scheme, though possibly a result of gradual changes over the years, may date it closer to 1860 than 1880. It is a classic example of the small-scale Italianate-style homes so popular in the area during this time period. The house has passed through the hands of many owners, and has often been used as a rental property. It was owned for nearly twenty years and occasionally occupied at the beginning of the twentieth century by William R. Coger, a carpenter and builder who may have built the two other houses on the block to the north.

21. SOURCES:

Corning City Directories; Steuben County Deeds; Sanborn Fire Insurance Maps of Corning, 1908, 1913, 1918, 1923, 1930, 1948; Assessment Records; Bird's-Eye View of Corning, 1882; Map of Corning, Harry C. Heermans, City Engineer, 1893; Building Permit Records.

MAP INFORMATION:

1882 - House exists on site, according to Bird's-Eye View

1893 - House exists on site, with name, "G. Hitchcock."

1908 - Wood-framed house exists at 224 Wall Street

CITY DIRECTORY INFORMATION:

1893 - No listing

1895 - No listing

1899 - No listing

1903 - Emil R. Stasch, president Corning Manufacturing Co., 9 E. Erie, home at 224 Wall

1905 - Mrs. Emma A. Husted, widow of Clark Husted, home at 224 Wall

1907 - Same

1909-10 - William R. Coger, carpenter, home at 224 Wall

DEED INFORMATION:

February 18, 1889 - Anna J. Bailey to Elmina L. Kress, Lot 9, Block 40, for \$3,500. Book 214, page 268.

Continuation Sheet, Page 3
224 Wall Street
Coming, New York

September 20, 1890 - Elmina L. Kress to George and Eliza Hitchcock, Lot 9, Block 40, for \$2,000.
Book 221, page 598.

March 4, 1901 - George Hitchcock to William R. Coger, Lot 9, Block 40, for \$2,500. Book 268, page
64.



↑ 224 Wall St.